

FOR LEASE

Office Space

4301 Olive Street • St. Louis, MO 63108

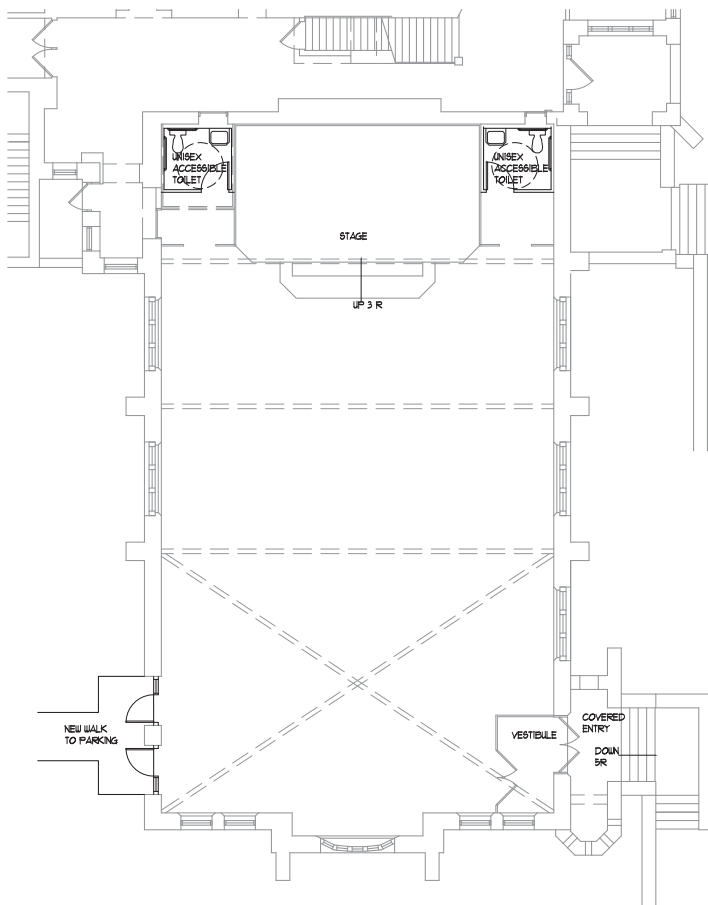

 **FLOOR PLAN**
SCALE: 1/8" = 1'-0"

3225 SF USABLE

- Bring your Creative Firm to this Unique Office Space currently in the process of rehab!
- 3,225 Sq. Ft. Space
- Church being renovated into office space
- Site has off street parking
- Conveniently located near the CWE, Grand Center & BJC.

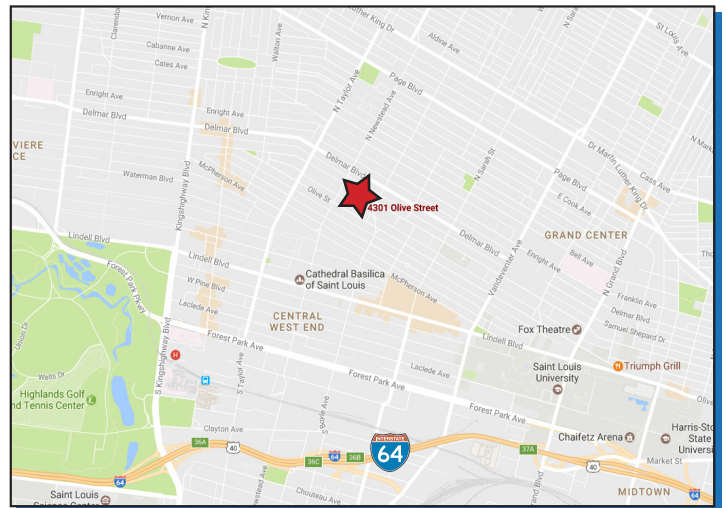

For more information contact:

Ken Wedberg

Direct: 314-446-7540

Cell: 314-374-6670

wedberg@realtyexchangeweb.com

**Offered at:
\$12 Sq Ft**



