

## FOR SALE

3640 Harvester Rd  
St. Peters, MO 63303



- P 1,232 SF Free-Standing Restaurant Building—compact, efficient layout ideal for quick-service concepts
- Former Sonic Drive-In with existing drive-in infrastructure and adaptable restaurant configuration
- Strong Visibility Along Harvester Road with consistent daily traffic

**\$530,000**

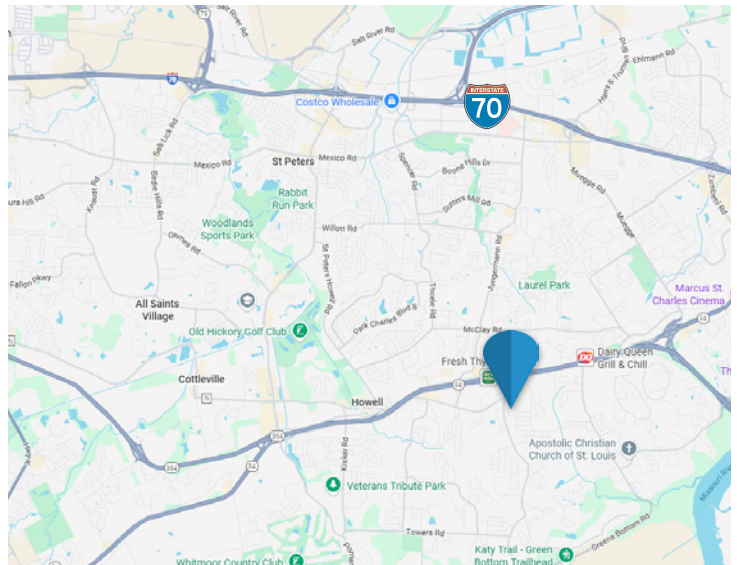

**Ken Wedberg**

Office: 314-446-7540

Cell: 314-374-6670

wedberg@realtyexchangeweb.com

**Sam Vandergriff**

Office: 314-647-0130 ext. 4055

Cell: 314-307-9336

vandergriff@realtyexchangeweb.com

Information contained herein has been obtained from the owner of the property or other sources. The Brokers do not guarantee the accuracy of this information. Sellers and Brokers make no representation as to the environmental or other conditions of the property and recommend that Purchaser(s) investigate fully.

## Summary

### The Offering

Realty Exchange has been retained as the exclusive agent to represent the aforementioned 3640 Harvester Rd. St. Peters, MO 63303.

### Investment Highlights

- 1,232 SF Free-Standing Restaurant Building—compact, efficient layout ideal for quick-service concepts
- Former Sonic Drive-In with existing drive-in infrastructure and adaptable restaurant configuration
- Currently Operating as a Breakfast Restaurant—turnkey setup for food-service operators or rebranding concepts
- Strong Visibility Along Harvester Road with consistent daily traffic
- Existing Drive-Thru Capability providing operational efficiency and expanded revenue potential
- Outdoor Parking & Canopy Areas suitable for patio dining or dedicated customer pickup
- Positioned in a Well-Established Retail Corridor surrounded by dense residential neighborhoods and complementary commercial uses
- Easy Access to Mid Rivers Mall Drive and Hwy 94 ensuring convenient customer reach
- Ideal for QSR, Fast Casual, Coffee, or Specialty Food Concepts seeking a ready-to-operate location
- .53 Acre Lot
- C-3 Zoning
- Taxes:
  - 2022 - \$4,469
  - 2023 - \$4,887
  - 2024 - \$4,893

---

#### **Ken Wedberg**

Office: 314-446-7540

Cell: 314-374-6670

[wedberg@realtyexchangeweb.com](mailto:wedberg@realtyexchangeweb.com)

#### **Sam Vandergriff**

Office: 314-647-0130 ext. 4055

Cell: 314-307-9336

[vandergriff@realtyexchangeweb.com](mailto:vandergriff@realtyexchangeweb.com)



## Location



Demographics	1 Mile	3 Mile	5 Mile
Population	12,099	86,377	161,316
Households	5,176	34,486	66,509
Average Household Income	\$110,469	\$129,743	\$121,844
Traffic Volume	15,530	21,693	79,535

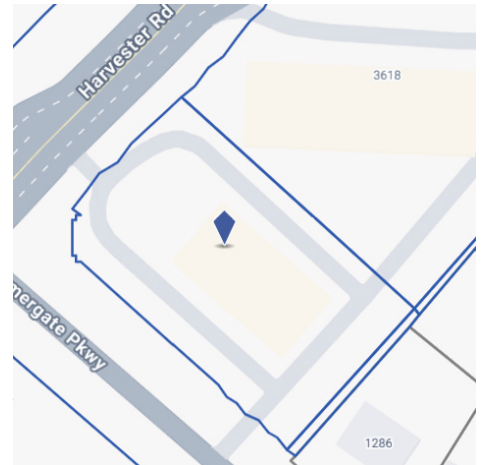

**Ken Wedberg**  
Office: 314-446-7540  
Cell: 314-374-6670  
[wedberg@realtyexchangeweb.com](mailto:wedberg@realtyexchangeweb.com)

**Sam Vandergriff**  
Office: 314-647-0130 ext. 4055  
Cell: 314-307-9336  
[vandergriff@realtyexchangeweb.com](mailto:vandergriff@realtyexchangeweb.com)

## Demographics



**5,176**  
HOUSEHOLDS



**11,152**  
POPULATION



**2.32**  
AVERAGE  
HOUSEHOLD SIZE



**\$110,469**  
AVERAGE  
HOUSEHOLD INCOME



**\$306,900**  
AVERAGE  
HOUSING VALUE



**96.1%**  
EMPLOYMENT



**70.8%**  
WHITE COLLAR  
WORKERS

---

**Ken Wedberg**

Office: 314-446-7540

Cell: 314-374-6670

[wedberg@realtyexchangeweb.com](mailto:wedberg@realtyexchangeweb.com)

**Sam Vandergriff**

Office: 314-647-0130 ext. 4055

Cell: 314-307-9336

[vandergriff@realtyexchangeweb.com](mailto:vandergriff@realtyexchangeweb.com)



**Ken Wedberg**

Office: 314-446-7540

Cell: 314-374-6670

[wedberg@realtyexchangeweb.com](mailto:wedberg@realtyexchangeweb.com)

**Sam Vandergriff**

Office: 314-647-0130 ext. 4055

Cell: 314-307-9336

[vandergriff@realtyexchangeweb.com](mailto:vandergriff@realtyexchangeweb.com)